

# TRAFFIC CRASH REPORT

\*DENOTES MANDATORY FIELD FOR SUPPLEMENT REPORT

LOCAL REPORT NUMBER \*

25-OPD-0067

<input type="checkbox"/> PHOTOS TAKEN <input type="checkbox"/> SECONDARY CRASH <input checked="" type="checkbox"/> PRIVATE PROPERTY		LOCAL INFORMATION REPORTING AGENCY NAME * Oxford Police Department		NCIC * 00907		HIT/SKIP 1 - SOLVED 2 - UNSOLVED		NUMBER OF UNITS 2		UNIT IN ERROR 98 - ANIMAL 99 - UNKNOWN			
COUNTY* 9		LOCALITY* 1 - CITY 2 - VILLAGE 3 - TOWNSHIP 1		LOCATION: CITY, VILLAGE, TOWNSHIP* Oxford		CRASH DATE / TIME* 01/28/2025 13:50		CRASH SEVERITY 1 - FATAL 2 - SERIOUS INJURY SUSPECTED 3 - MINOR INJURY SUSPECTED 4 - INJURY POSSIBLE 5 - PROPERTY DAMAGE ONLY					
ROUTE TYPE LOCATION		ROUTE NUMBER LOCATION		PREFIX 1 - NORTH 2 - SOUTH 3 - EAST 4 - WEST		LOCATION ROAD NAME Red Cloud		ROAD TYPE CT		LATITUDE DECIMAL DEGREES 39.490849			
ROUTE TYPE REFERENCE		ROUTE NUMBER REFERENCE		PREFIX 1 - NORTH 2 - SOUTH 3 - EAST 4 - WEST		REFERENCE ROAD NAME (ROAD, MILEPOST, HOUSE #) 5141		ROAD TYPE		LONGITUDE DECIMAL DEGREES -84.725600			
REFERENCE POINT 1 - INTERSECTION 2 - MILE POST 3 - HOUSE # 3		DIRECTION FROM REFERENCE 1 - NORTH 2 - SOUTH 3 - EAST 4 - WEST		ROUTE TYPE IR - INTERSTATE ROUTE (TP) US - FEDERAL US ROUTE SR - STATE ROUTE CR - NUMBERED COUNTY ROUTE TR - NUMBERED TOWNSHIP ROUTE		ROAD TYPE AL - ALLEY AV - AVENUE BL - BOULEVARD CR - CIRCLE CT - COURT DR - DRIVE HE - HEIGHTS		HW - HIGHWAY LA - LANE MP - MILEPOST OV - OVAL PK - PARKWAY PI - PIKE PL - PLACE		RD - ROAD SQ - SQUARE ST - STREET TE - TERRACE TL - TRAIL WA - WAY			
INTERSECTION RELATED <input type="checkbox"/> WITHIN INTERSECTION OR ON APPROACH <input type="checkbox"/> WITHIN INTERCHANGE AREA		NUMBER OF APPROACHES _____		ROADWAY <input type="checkbox"/> ROADWAY DIVIDED									
LOCATION OF FIRST HARMFUL EVENT 1 - ON ROADWAY 2 - ON SHOULDER 3 - IN MEDIAN 4 - ON ROADSIDE 5 - ON GORE 6 - OUTSIDE TRAFFIC WAY 7 - ON RAMP 8 - OFF RAMP 6				MANNER OF CRASH COLLISION/IMPACT 1 - NOT COLLISION BETWEEN TWO MOTOR VEHICLES IN TRANSPORT 2 - REAR-END 3 - HEAD-ON 4 - REAR-TO-REAR 5 - BACKING 6 - ANGLE 7 - SIDESWIPE, SAME DIRECTION 8 - SIDESWIPE, OPPOSITE DIRECTION 9 - OTHER / UNKNOWN 6				DIRECTION OF TRAVEL 1 - NORTH 2 - SOUTH 3 - EAST 4 - WEST		MEDIAN TYPE 1 - DIVIDED FLUSH MEDIAN (<4 FEET) 2 - DIVIDED FLUSH MEDIAN (≥4 FEET) 3 - DIVIDED, DEPRESSED MEDIAN 4 - DIVIDED, RAISED MEDIAN (ANY TYPE) 9 - OTHER / UNKNOWN			
<input type="checkbox"/> WORK ZONE RELATED <input type="checkbox"/> WORKERS PRESENT <input type="checkbox"/> LAW ENFORCEMENT PRESENT <input type="checkbox"/> ACTIVE SCHOOL ZONE		WORK ZONE TYPE 1 - LANE CLOSURE 2 - LANE SHIFT/ CROSSOVER 3 - WORK ON SHOULDER OR MEDIAN 4 - INTERMITTENT OR MOVING WORK 5 - OTHER		LOCATION OF CRASH IN WORK ZONE 1 - BEFORE THE 1ST WORK ZONE WARNING SIGN 2 - ADVANCE WARNING AREA 3 - TRANSITION AREA 4 - ACTIVITY AREA 5 - TERMINATION AREA		CONTOUR 1 1 - STRAIGHT LEVEL 2 - STRAIGHT GRADE 3 - CURVE LEVEL 4 - CURVE GRADE 9 - OTHER /UNKNOWN		CONDITIONS 1 1 - DRY 2 - WET 3 - SNOW 4 - ICE 5 - SAND, MUD, DIRT, OIL, GRAVEL 6 - WATER (STANDING, MOVING) 7 - SLUSH 9 - OTHER / UNKNOWN		SURFACE 2 1 - CONCRETE 2 - BLACKTOP, BITUMINOUS, ASPHALT 3 - BRICK/BLOCK 4 - SLAG, GRAVEL, STONE 5 - DIRT 9 - OTHER / UNKNOWN			
LIGHT CONDITION 1 1 - DAYLIGHT 2 - DAWN/DUSK 3 - DARK - LIGHTED ROADWAY 4 - DARK - ROADWAY NOT LIGHTED 5 - DARK - UNKNOWN ROADWAY LIGHTING 9 - OTHER / UNKNOWN				WEATHER 1 1 - CLEAR 2 - CLOUDY 3 - FOG, SMOG, SMOKE 4 - RAIN 5 - SLEET, HAIL 6 - SNOW 7 - SEVERE CROSSWINDS 8 - BLOWING SAND, SOIL, DIRT, SNOW 9 - FREEZING RAIN OR FREEZING DRIZZLE 99 - OTHER / UNKNOWN				NARRATIVE I spoke to both drivers involved in a minor crash on private property in a parking lot. Driver of Unit 1 stated that as he was traveling on Red Cloud Ct, a vehicle began backing out of a parking space and hit his passenger side of his truck. Driver of Unit 2 stated that he was sitting in his vehicle without the vehicle running, and that Unit 1 simply got too close to the back of his vehicle and hit the rear bumper and lift gate. Both drivers stayed with their stories, there were no independent witnesses, and no cameras in the area. I advised both drivers that I would complete a private property crash indicating their respective stories of what caused the crash.					
CRASH REPORTED DATE / TIME 01/28/2025 13:50						DISPATCH DATE / TIME 01/28/2025 13:51		ARRIVAL DATE / TIME 01/28/2025 13:59		SCENE CLEARED DATE / TIME 01/28/2025 15:18			
TOTAL TIME ROADWAY CLOSED _____		OTHER INVESTIGATION TIME _____		TOTAL MINUTES 87		OFFICER'S NAME* Carlson, Derrick		CHECKED BY OFFICER'S NAME* Hatfield, Matthew		REPORT TAKEN BY <input checked="" type="checkbox"/> POLICE AGENCY <input type="checkbox"/> MOTORIST			
OFFICER'S BADGE NUMBER* 50				CHECKED BY OFFICER'S BADGE NUMBER* 35				<input type="checkbox"/> SUPPLEMENT (CORRECTION OR ADDITION TO AN EXISTING REPORT SENT TO ODPS)					

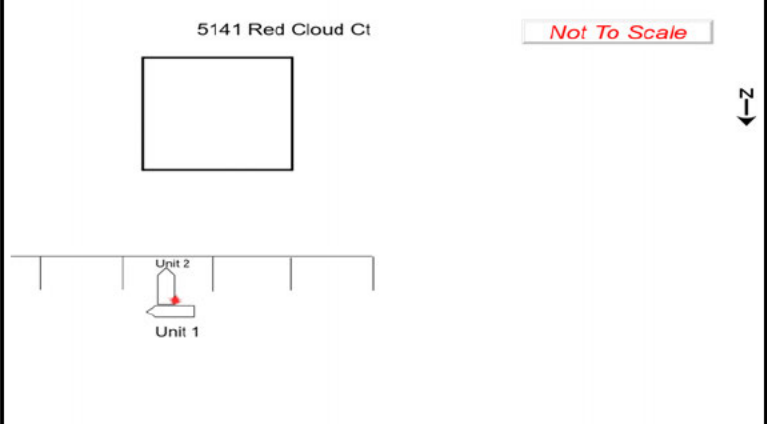

**OWNER**

**UNIT #** 1 **OWNER NAME:** LAST, FIRST, MIDDLE (  SAME AS DRIVER )  
COMER, CHASTITY

**OWNER ADDRESS:** STREET, CITY, STATE, ZIP (  SAME AS DRIVER )  
62 WEXFORD CV , HUMBOLDT, TN, 383438649

**COMMERCIAL CARRIER:** NAME, ADDRESS, CITY, STATE, ZIP \_\_\_\_\_ **COMMERCIAL CARRIER PHONE:** INCLUDE AREA CODE \_\_\_\_\_

**DAMAGE**

**DAMAGE SCALE**

1 - NONE 3 - FUNCTIONAL DAMAGE  
2 - MINOR DAMAGE 4 - DISABLING DAMAGE  
9 - UNKNOWN

2

**VEHICLE**

**LP STATE** TN **LICENSE PLATE #** 030 BLFQ **VEHICLE IDENTIFICATION #** 1GTP9EEDXKZ278741 **VEHICLE YEAR** 2019 **VEHICLE MAKE** GMC

**INSURANCE VERIFIED** **INSURANCE COMPANY** FARM BUREAU INSURANCE **INSURANCE POLICY #** 0982182 **COLOR** MAR **VEHICLE MODEL** SIERRA

**COMMERCIAL**  **GOVERNMENT**  **IN EMERGENCY RESPONSE** **US DOT #** \_\_\_\_\_ **TOWED BY:** COMPANY NAME \_\_\_\_\_

**INTERLOCK DEVICE EQUIPPED**  **HIT/SKIP UNIT** **# OCCUPANTS** 1 **VEHICLE WEIGHT GVWR/GCWR**  
1 - ≤10K LBS.  
2 - 10.001 - 26K LBS.  
3 - > 26K LBS.

**MATERIAL RELEASED** **HAZARDOUS MATERIAL CLASS #** \_\_\_\_\_ **PLACARD ID #** \_\_\_\_\_

**DAMAGED AREA(S)**  
INDICATE ALL THAT APPLY

**NO DAMAGE** [ 0 ]  **UNDERCARRIAGE** [ 14 ]  
 **TOP** [ 13 ]  **ALL AREAS** [ 15 ]  
 **UNIT NOT AT SCENE** [ 16 ]

**UNIT TYPE** 4

**# of TRAILING UNITS** 0

**WAS VEHICLE OPERATING IN AUTONOMOUS MODE WHEN CRASH OCCURRED?**  
0 - NO AUTOMATION 3 - CONDITIONAL AUTOMATION 9 - OTHER/UNKNOWN  
1 - DRIVER ASSISTANCE 4 - HIGH AUTOMATION  
2 - PARTIAL AUTOMATION 5 - FULL AUTOMATION

**SPECIAL FUNCTION** 1

**CARGO BODY TYPE** 1

**VEHICLE DEFECTS**

**INITIAL POINT of CONTACT**

0 - NO DAMAGE 14 - UNDERCARRIAGE  
1-12 - REFER TO UNIT DIAGRAM 15 - VEHICLE NOT AT SCENE  
99 - UNKNOWN

2

13 - TOP

**NON-MOTORIST LOCATION** 1

**ACTION** 9

**PRE-CRASH ACTIONS** 1

**CONTRIBUTING CIRCUMSTANCES** 22

**SEQUENCE of EVENTS**

**EVENTS**

**TRAFFIC**

**TRAFFICWAY FLOW**  
1 - ONE-WAY  
2 - TWO-WAY

**TRAFFIC CONTROL**  
1 - ROUNDABOUT 4 - STOP SIGN  
2 - SIGNAL 5 - YIELD SIGN  
3 - FLASHER 6 - NO CONTROL

**# of THROUGH LANES on ROAD** 2

**RAIL GRADE CROSSING**  
1 - NOT INVOLVED  
2 - INVOLVED-ACTIVE CROSSING  
3 - INVOLVED-PASSIVE CROSSING

**EVENTS (6)**

1  20 **FIRST HARMFUL EVENT**

2 \_\_\_\_\_

3 \_\_\_\_\_

4 \_\_\_\_\_

5 \_\_\_\_\_

6 \_\_\_\_\_

1  **MOST HARMFUL EVENT**

**COLLISION with FIXED OBJECT - STRUCK**

25 - IMPACT ATTENUATOR / CRASH CUSHION  
26 - BRIDGE OVERHEAD STRUCTURE  
27 - BRIDGE PIER OR ABUTMENT  
28 - BRIDGE PARAPET  
29 - BRIDGE RAIL  
30 - GUARDRAIL FACE  
31 - GUARDRAIL END  
32 - PORTABLE BARRIER  
33 - MEDIAN CABLE BARRIER  
34 - MEDIAN GUARDRAIL BARRIER  
35 - MEDIAN CONCRETE BARRIER  
36 - MEDIAN OTHER BARRIER  
37 - TRAFFIC SIGN POST  
38 - OVERHEAD SIGN POST  
39 - LIGHT / LUMINARIES SUPPORT  
40 - UTILITY POLE  
41 - OTHER POST, POLE OR SUPPORT  
42 - CULVERT  
43 - CURB  
44 - DITCH  
45 - EMBANKMENT  
46 - FENCE  
47 - MAILBOX  
48 - TREE  
49 - FIRE HYDRANT  
50 - WORK ZONE MAINTENANCE EQUIPMENT  
51 - WALL  
52 - BUILDING  
53 - TUNNEL  
54 - OTHER FIXED OBJECT  
55 - OTHER / UNKNOWN

**UNIT / NON-MOTORIST DIRECTION**

FROM  4 TO  3

1 - NORTH 5 - NORTHEAST  
2 - SOUTH 6 - NORTHWEST  
3 - EAST 7 - SOUTHEAST  
4 - WEST 8 - SOUTHWEST  
9 - OTHER / UNKNOWN

**UNIT SPEED**

**POSTED SPEED**

**DETECTED SPEED**  
1 - STATED / ESTIMATED SPEED  
2 - CALCULATED / EDR  
3 - UNDETERMINED

<b>OWNER</b>	<b>UNIT #</b> 2	<b>OWNER NAME:</b> LAST, FIRST, MIDDLE ( <input type="checkbox"/> SAME AS DRIVER ) SCARLATO, NICHOLAS	<b>OWNER PHONE:</b> INCLUDE AREA CODE ( <input type="checkbox"/> SAME AS DRIVER ) [REDACTED]
	<b>OWNER ADDRESS:</b> STREET, CITY, STATE, ZIP ( <input type="checkbox"/> SAME AS DRIVER ) 6551 MULLEN RD, CINCINNATI, OH, 452473334		
	<b>COMMERCIAL CARRIER:</b> NAME, ADDRESS, CITY, STATE, ZIP		<b>COMMERCIAL CARRIER PHONE:</b> INCLUDE AREA CODE

<b>LP STATE</b> OH	<b>LICENSE PLATE #</b> KNU6931	<b>VEHICLE IDENTIFICATION #</b> JM3KE2BE5D0143635	<b>VEHICLE YEAR</b> 2013	<b>VEHICLE MAKE</b> MAZDA
<input checked="" type="checkbox"/> <b>INSURANCE VERIFIED</b>	<b>INSURANCE COMPANY</b> STATE FARM	<b>INSURANCE POLICY #</b> 2064218-SFP-35	<b>COLOR</b> BLU	<b>VEHICLE MODEL</b> CX-5

<input type="checkbox"/> <b>COMMERCIAL</b>	<input type="checkbox"/> <b>GOVERNMENT</b>	<input type="checkbox"/> <b>IN EMERGENCY RESPONSE</b>	<b>US DOT #</b>	<b>TOWED BY:</b> COMPANY NAME
<input type="checkbox"/> <b>INTERLOCK DEVICE EQUIPPED</b>	<input type="checkbox"/> <b>HIT/SKIP UNIT</b>	<b># OCCUPANTS</b> 1	<b>VEHICLE WEIGHT GVWR/GCWR</b> 1 - ≤ 10K LBS. 2 - 10.001 - 26K LBS. 3 - > 26K LBS.	<b>HAZARDOUS MATERIAL</b> <input type="checkbox"/> MATERIAL RELEASED <input type="checkbox"/> PLACARD

<b>UNIT TYPE</b> 3	1 - PASSENGER CAR 2 - PASSENGER VAN (MINIVAN) 3 - SPORT UTILITY VEHICLE 4 - PICK UP 5 - CARGO VAN	6 - VAN (9-15 SEATS) 7 - MOTORCYCLE 2-WHEELED 8 - MOTORCYCLE 3-WHEELED 9 - AUTOCYCLE 10 - MOPEL OR MOTORIZED BICYCLE 11 - ALL TERRAIN VEHICLE (ATV/UTV)	12 - GOLF CART 13 - SNOWMOBILE 14 - SINGLE UNIT TRUCK 15 - SEMI-TRACTOR 16 - FARM EQUIPMENT 17 - MOTORHOME	18 - LIMO (LIVERY VEHICLE) 19 - BUS (16+ PASSENGERS) 20 - OTHER VEHICLE 21 - HEAVY EQUIPMENT 22 - ANIMAL WITH RIDER OR ANIMAL-DRAWN VEHICLE	23 - PEDESTRIAN/SKATER 24 - WHEELCHAIR (ANY TYPE) 25 - OTHER NON-MOTORIST 26 - BICYCLE 27 - TRAIN 99 - UNKNOWN OR HIT/SKIP
-----------------------	---------------------------------------------------------------------------------------------------------------	------------------------------------------------------------------------------------------------------------------------------------------------------------------------	---------------------------------------------------------------------------------------------------------------------------	---------------------------------------------------------------------------------------------------------------------------------------------------------	-------------------------------------------------------------------------------------------------------------------------------------------

<b>WAS VEHICLE OPERATING IN AUTONOMOUS MODE WHEN CRASH OCCURRED?</b> 2	1 - YES 2 - NO 9 - OTHER / UNKNOWN	<b>AUTONOMOUS MODE LEVEL</b> 0	0 - NO AUTOMATION 1 - DRIVER ASSISTANCE 2 - PARTIAL AUTOMATION 3 - CONDITIONAL AUTOMATION 4 - HIGH AUTOMATION 5 - FULL AUTOMATION 9 - OTHER/UNKNOWN
---------------------------------------------------------------------------	------------------------------------------	-----------------------------------	-----------------------------------------------------------------------------------------------------------------------------------------------------------------------

<b>SPECIAL FUNCTION</b> 1	1 - NONE 2 - TAXI 3 - ELECTRONIC RIDE SHARING 4 - SCHOOL TRANSPORT 5 - BUS - TRANSIT/COMMUTER	6 - BUS - CHARTER/TOUR 7 - BUS - INTERCITY 8 - BUS - SHUTTLE 9 - BUS - OTHER 10 - AMBULANCE	11 - FIRE 12 - MILITARY 13 - POLICE 14 - PUBLIC UTILITY 15 - CONSTRUCTION EQUIP.	16 - FARM 17 - MOWING 18 - SNOW REMOVAL 19 - TOWING 20 - SAFETY SERVICE PATROL	21 - MAIL CARRIER 99 - OTHER / UNKNOWN
------------------------------	-----------------------------------------------------------------------------------------------------------	---------------------------------------------------------------------------------------------------------	----------------------------------------------------------------------------------------------	--------------------------------------------------------------------------------------------	-------------------------------------------

<b>VEHICLE DEFECTS</b>	1 - TURN SIGNALS 2 - HEAD LAMPS 3 - TAIL LAMPS	4 - BRAKES 5 - STEERING 6 - TIRE BLOWOUT	7 - WORN OR SLICK TIRES 8 - TRAILER EQUIPMENT DEFECTIVE 9 - MOTOR TROUBLE 10 - DISABLED FROM PRIOR ACCIDENT	99 - OTHER / UNKNOWN
------------------------	------------------------------------------------------	------------------------------------------------	----------------------------------------------------------------------------------------------------------------------	----------------------

<b>NON-MOTORIST LOCATION</b>	1 - INTERSECTION - MARKED CROSSWALK 2 - INTERSECTION - UNMARKED CROSSWALK 3 - INTERSECTION - OTHER	4 - MIDBLOCK - MARKED CROSSWALK 5 - TRAVEL LANE - OTHER LOCATION 6 - BICYCLE LANE	7 - SHOULDER/ROADSIDE 8 - SIDEWALK 9 - MEDIAN/CROSSING ISLAND	10 - DRIVEWAY ACCESS 11 - SHARED USE PATHS OR TRAILS 12 - FIRST RESPONDER AT INCIDENT SCENE	99 - OTHER / UNKNOWN
------------------------------	----------------------------------------------------------------------------------------------------------	-----------------------------------------------------------------------------------------	---------------------------------------------------------------------	---------------------------------------------------------------------------------------------------	----------------------

<b>ACTION</b> 9	1 - NON-CONTACT 2 - NON-COLLISION 3 - STRIKING 4 - STRUCK 5 - BOTH STRIKING & STRUCK 9 - OTHER / UNKNOWN	<b>PRE-CRASH ACTIONS</b> 99	1 - STRAIGHT AHEAD 2 - BACKING 3 - CHANGING LANES 4 - OVERTAKING/PASSING 5 - MAKING RIGHT TURN 6 - MAKING LEFT TURN 7 - MAKING U-TURN 8 - ENTERING TRAFFIC LANE	9 - LEAVING TRAFFIC LANE 10 - PARKED 11 - SLOWING OR STOPPED IN TRAFFIC 12 - DRIVERLESS 13 - NEGOTIATING A CURVE 14 - ENTERING OR CROSSING SPECIFIED LOCATION	15 - WALKING, RUNNING, JOGGING, PLAYING 16 - WORKING 17 - PUSHING VEHICLE 18 - APPROACHING OR LEAVING VEHICLE 19 - STANDING 20 - OTHER NON-MOTORIST	21 - STANDING OUTSIDE DISABLED VEHICLE 99 - OTHER / UNKNOWN
--------------------	-------------------------------------------------------------------------------------------------------------------------	--------------------------------	--------------------------------------------------------------------------------------------------------------------------------------------------------------------------------------	------------------------------------------------------------------------------------------------------------------------------------------------------------------------------	--------------------------------------------------------------------------------------------------------------------------------------------------------------------	----------------------------------------------------------------

<b>CONTRIBUTING CIRCUMSTANCES</b> 22	1 - NONE 2 - FAILURE TO YIELD 3 - RAN RED LIGHT 4 - RAN STOP SIGN 5 - UNSAFE SPEED 6 - IMPROPER TURN 7 - LEFT OF CENTER	8 - FOLLOWING TOO CLOSE /ACDA 9 - IMPROPER LANE CHANGE 10 - IMPROPER PASSING 11 - DROVE OFF ROAD 12 - IMPROPER BACKING	13 - IMPROPER START FROM A PARKED POSITION 14 - STOPPED OR PARKED ILLEGALLY 15 - SWERVING TO AVOID 16 - WRONG WAY 17 - VISION OBSTRUCTION	18 - OPERATING DEFECTIVE EQUIPMENT 19 - LOAD SHIFTING /FALLING/SPILLING 20 - IMPROPER CROSSING 21 - LYING IN ROADWAY 22 - NOT DISCERNIBLE	23 - OPENING DOOR INTO ROADWAY 99 - OTHER IMPROPER ACTION
-----------------------------------------	-------------------------------------------------------------------------------------------------------------------------------------------	------------------------------------------------------------------------------------------------------------------------------------	-------------------------------------------------------------------------------------------------------------------------------------------------------	-------------------------------------------------------------------------------------------------------------------------------------------------------	--------------------------------------------------------------

<b>SEQUENCE OF EVENTS</b>	<b>EVENTS</b>
1 [20]	1 - OVERTURN/ROLLOVER 2 - FIRE/EXPLOSION 3 - IMMERSION 4 - JACKKNIFE 5 - CARGO / EQUIPMENT LOSS OR SHIFT 6 - EQUIPMENT FAILURE
2 [ ]	7 - SEPARATION OF UNITS 8 - RAN OFF ROAD RIGHT 9 - RAN OFF ROAD LEFT 10 - CROSS MEDIAN 11 - CROSS CENTERLINE - OPPOSITE DIRECTION OF TRAVEL
3 [ ]	12 - DOWNHILL RUNAWAY 13 - OTHER NON-COLLISION 14 - PEDESTRIAN 15 - PEDALCYCLE 16 - RAILWAY VEHICLE 17 - ANIMAL - FARM 18 - ANIMAL - DEER
4 [ ]	19 - ANIMAL - OTHER 20 - MOTOR VEHICLE IN TRANSPORT 21 - PARKED MOTOR VEHICLE 22 - WORK ZONE MAINTENANCE EQUIPMENT
5 [ ]	23 - STRUCK BY FALLING, SHIFTING CARGO OR ANYTHING SET IN MOTION BY A MOTOR VEHICLE 24 - OTHER MOVABLE OBJECT
6 [ ]	<b>COLLISION WITH FIXED OBJECT - STRUCK</b> 25 - IMPACT ATTENUATOR / CRASH CUSHION 26 - BRIDGE OVERHEAD STRUCTURE 27 - BRIDGE PIER OR ABUTMENT 28 - BRIDGE PARAPET 29 - BRIDGE RAIL 30 - GUARDRAIL FACE
1 [ ]	31 - GUARDRAIL END 32 - PORTABLE BARRIER 33 - MEDIAN CABLE BARRIER 34 - MEDIAN GUARDRAIL BARRIER 35 - MEDIAN CONCRETE BARRIER 36 - MEDIAN OTHER BARRIER 37 - TRAFFIC SIGN POST
1 [ ]	38 - OVERHEAD SIGN POST 39 - LIGHT / LUMINARIES SUPPORT 40 - UTILITY POLE 41 - OTHER POST, POLE OR SUPPORT 42 - CULVERT 43 - CURB 44 - DITCH
1 [ ]	45 - EMBANKMENT 46 - FENCE 47 - MAILBOX 48 - TREE 49 - FIRE HYDRANT 50 - WORK ZONE MAINTENANCE EQUIPMENT 51 - WALL
1 [ ]	52 - BUILDING 53 - TUNNEL 54 - OTHER FIXED OBJECT 99 - OTHER / UNKNOWN

**DAMAGE**

**DAMAGE SCALE**

1 - NONE  
2 - MINOR DAMAGE  
9 - UNKNOWN

3 - FUNCTIONAL DAMAGE  
4 - DISABLING DAMAGE

**DAMAGED AREA(S)**  
INDICATE ALL THAT APPLY

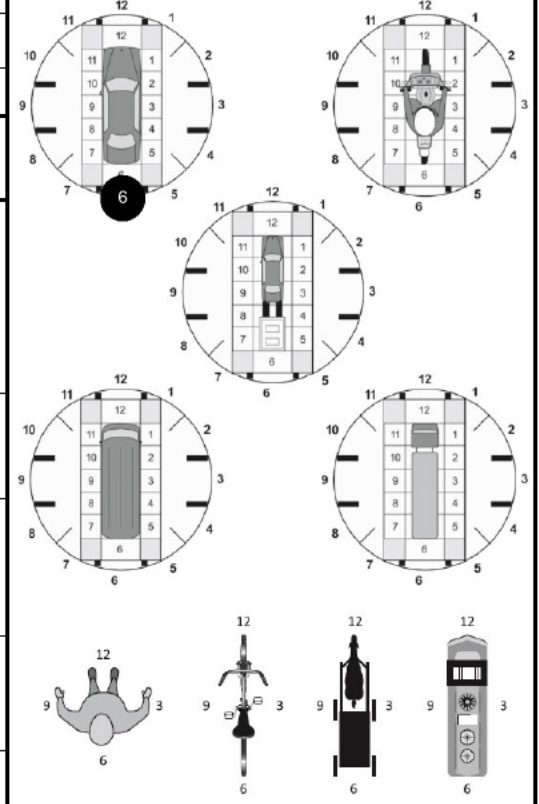

NO DAMAGE [ 0 ]     UNDERCARRIAGE [ 14 ]

TOP [ 13 ]     ALL AREAS [ 15 ]

UNIT NOT AT SCENE [ 16 ]

**INITIAL POINT OF CONTACT**

0 - NO DAMAGE  
1-12 - REFER TO UNIT DIAGRAM  
13 - TOP

14 - UNDERCARRIAGE  
15 - VEHICLE NOT AT SCENE  
99 - UNKNOWN

**TRAFFIC**

<b>TRAFFICWAY FLOW</b> 1 - ONE-WAY 2 - TWO-WAY	<b>TRAFFIC CONTROL</b> 1 - ROUNDABOUT 2 - SIGNAL 3 - FLASHER	6	<b>4 - STOP SIGN</b> 5 - YIELD SIGN 6 - NO CONTROL
------------------------------------------------------	-----------------------------------------------------------------------	---	----------------------------------------------------------

<b># OF THROUGH LANES ON ROAD</b> 2	<b>RAIL GRADE CROSSING</b> 1 - NOT INVOLVED 2 - INVOLVED-ACTIVE CROSSING 3 - INVOLVED-PASSIVE CROSSING
----------------------------------------	-----------------------------------------------------------------------------------------------------------------

**UNIT / NON-MOTORIST DIRECTION**

FROM [ ] TO [ ]

1 - NORTH  
2 - SOUTH  
3 - EAST  
4 - WEST

5 - NORTHEAST  
6 - NORTHWEST  
7 - SOUTHEAST  
8 - SOUTHWEST  
9 - OTHER / UNKNOWN

<b>UNIT SPEED</b> [ ]	<b>DETECTED SPEED</b> 1 - STATED / ESTIMATED SPEED
<b>POSTED SPEED</b> [ ]	2 - CALCULATED / EDR 3 - UNDETERMINED

# MOTORIST / Non-MOTORIST

LOCAL REPORT NUMBER  
25-OPD-0067

<b>UNIT #</b> 1	<b>NAME: LAST, FIRST, MIDDLE</b> WILLIAMSON, DARION, M				<b>DATE OF BIRTH</b> 07/02/2002		<b>AGE</b> 22	<b>GENDER</b> M			
<b>ADDRESS: STREET, CITY, STATE, ZIP</b> 9868 HIGHWAY 76 S, STANTON, TN, 380693628					<b>CONTACT PHONE - INCLUDE AREA CODE</b> [REDACTED]						
<b>INJURIES</b> 5	<b>INJURED TAKEN BY</b> [REDACTED]	<b>EMS AGENCY (NAME)</b>	<b>INJURED TAKEN TO: MEDICAL FACILITY (NAME, CITY)</b>		<b>SAFETY EQUIPMENT USED</b> 4	<input type="checkbox"/> DOT-COMPLIANT <input checked="" type="checkbox"/> MC HELMET	<b>SEATING POSITION</b> 1	<b>AIR BAG USAGE</b> 1	<b>EJECTION</b> 1	<b>TRAPPED</b> 1	
<b>OL STATE</b> [REDACTED]	<b>OPERATOR LICENSE NUMBER</b> [REDACTED]		<b>OFFENSE CHARGED</b>		<b>LOCAL CODE</b> [REDACTED]	<b>OFFENSE DESCRIPTION</b>		<b>CITATION NUMBER</b>			
<b>OL CLASS</b> 4	<b>ENDORSEMENT</b>	<b>RESTRICTION SELECT UP TO 3</b>		<b>DRIVER DISTRACTED BY</b> 1	<b>ALCOHOL / DRUG SUSPECTED</b> <input type="checkbox"/> ALCOHOL <input type="checkbox"/> MARIJUANA <input type="checkbox"/> OTHER DRUG		<b>CONDITION</b> 1	<b>ALCOHOL TEST</b>		<b>DRUG TEST(S)</b>	
						STATUS		TYPE		RESULTS SELECT UP TO 4	
						1		1		1	

<b>UNIT #</b> 2	<b>NAME: LAST, FIRST, MIDDLE</b> SCARLATO, NICHOLAS				<b>DATE OF BIRTH</b> 06/02/1975		<b>AGE</b> 49	<b>GENDER</b> M			
<b>ADDRESS: STREET, CITY, STATE, ZIP</b> 6551 MULLEN RD, CINCINNATI, OH, 452473334					<b>CONTACT PHONE - INCLUDE AREA CODE</b> [REDACTED]						
<b>INJURIES</b> 5	<b>INJURED TAKEN BY</b> [REDACTED]	<b>EMS AGENCY (NAME)</b>	<b>INJURED TAKEN TO: MEDICAL FACILITY (NAME, CITY)</b>		<b>SAFETY EQUIPMENT USED</b> 1	<input type="checkbox"/> DOT-COMPLIANT <input checked="" type="checkbox"/> MC HELMET	<b>SEATING POSITION</b> 1	<b>AIR BAG USAGE</b> 1	<b>EJECTION</b> 1	<b>TRAPPED</b> 1	
<b>OL STATE</b> [REDACTED]	<b>OPERATOR LICENSE NUMBER</b> [REDACTED]		<b>OFFENSE CHARGED</b>		<b>LOCAL CODE</b> [REDACTED]	<b>OFFENSE DESCRIPTION</b>		<b>CITATION NUMBER</b>			
<b>OL CLASS</b> 4	<b>ENDORSEMENT</b>	<b>RESTRICTION SELECT UP TO 3</b>		<b>DRIVER DISTRACTED BY</b> 1	<b>ALCOHOL / DRUG SUSPECTED</b> <input type="checkbox"/> ALCOHOL <input type="checkbox"/> MARIJUANA <input type="checkbox"/> OTHER DRUG		<b>CONDITION</b> 1	<b>ALCOHOL TEST</b>		<b>DRUG TEST(S)</b>	
						STATUS		TYPE		RESULTS SELECT UP TO 4	
						1		1		1	

<b>UNIT #</b>	<b>NAME: LAST, FIRST, MIDDLE</b>				<b>DATE OF BIRTH</b>		<b>AGE</b>	<b>GENDER</b>			
<b>ADDRESS: STREET, CITY, STATE, ZIP</b>					<b>CONTACT PHONE - INCLUDE AREA CODE</b>						
<b>INJURIES</b>	<b>INJURED TAKEN BY</b>	<b>EMS AGENCY (NAME)</b>	<b>INJURED TAKEN TO: MEDICAL FACILITY (NAME, CITY)</b>		<b>SAFETY EQUIPMENT USED</b>	<input type="checkbox"/> DOT-COMPLIANT <input checked="" type="checkbox"/> MC HELMET	<b>SEATING POSITION</b>	<b>AIR BAG USAGE</b>	<b>EJECTION</b>	<b>TRAPPED</b>	
<b>OL STATE</b>	<b>OPERATOR LICENSE NUMBER</b>		<b>OFFENSE CHARGED</b>		<b>LOCAL CODE</b>	<b>OFFENSE DESCRIPTION</b>		<b>CITATION NUMBER</b>			
<b>OL CLASS</b>	<b>ENDORSEMENT</b>	<b>RESTRICTION SELECT UP TO 3</b>		<b>DRIVER DISTRACTED BY</b>	<b>ALCOHOL / DRUG SUSPECTED</b>		<b>CONDITION</b>	<b>ALCOHOL TEST</b>		<b>DRUG TEST(S)</b>	
						STATUS		TYPE		RESULTS SELECT UP TO 4	
						1		1		1	

INJURIES	SEATING POSITION	AIR BAG	OL CLASS	OL RESTRICTION(S)	DRIVER DISTRACTION	TEST STATUS
1 - FATAL 2 - SUSPECTED SERIOUS INJURY 3 - SUSPECTED MINOR INJURY 4 - POSSIBLE INJURY 5 - NO APPARENT INJURY	1 - FRONT - LEFT SIDE (MOTORCYCLE DRIVER) 2 - FRONT - MIDDLE 3 - FRONT - RIGHT SIDE 4 - SECOND - LEFT SIDE (MOTORCYCLE PASSENGER) 5 - SECOND - MIDDLE 6 - SECOND - RIGHT SIDE 7 - THIRD - LEFT SIDE (MOTORCYCLE SIDE CAR) 8 - THIRD - MIDDLE 9 - THIRD - RIGHT SIDE 10 - SLEEPER SECTION OF TRUCK CAB 11 - PASSENGER IN OTHER ENCLOSED CARGO AREA (NON-TRAILING UNIT, BUS, PICK-UP WITH CAP) 12 - PASSENGER IN UNENCLOSED CARGO AREA 13 - TRAILING UNIT 14 - RIDING ON VEHICLE EXTERIOR (NON-TRAILING UNIT) 15 - NON-MOTORIST 99 - OTHER / UNKNOWN	1 - NOT DEPLOYED 2 - DEPLOYED FRONT 3 - DEPLOYED SIDE 4 - DEPLOYED BOTH FRONT/SIDE 5 - NOT APPLICABLE 9 - DEPLOYMENT UNKNOWN	1 - CLASS A 2 - CLASS B 3 - CLASS C 4 - REGULAR CLASS (OHIO = D) 5 - M/C MOPED ONLY 6 - NO VALID OL	1 - ALCOHOL INTERLOCK DEVICE 2 - CDL INTRASTATE ONLY 3 - CORRECTIVE LENSES 4 - FARM WAIVER 5 - EXCEPT CLASS A BUS 6 - EXCEPT CLASS A & CLASS B BUS 7 - EXCEPT TRACTOR-TRAILER 8 - INTERMEDIATE LICENSE RESTRICTIONS 9 - LEARNER'S PERMIT RESTRICTIONS 10 - LIMITED TO DAYLIGHT ONLY 11 - LIMITED TO EMPLOYMENT 12 - LIMITED - OTHER 13 - MECHANICAL DEVICES (SPECIAL BRAKES, HAND CONTROLS, OR OTHER ADAPTIVE DEVICES) 14 - MILITARY VEHICLES ONLY 15 - MOTOR VEHICLES WITHOUT AIR BRAKES 16 - OUTSIDE MIRROR 17 - PROSTHETIC AID 18 - OTHER	1 - NOT DISTRACTED 2 - MANUALLY OPERATING AN ELECTRONIC COMMUNICATION DEVICE (TEXTING, TYPING, DIALING) 3 - TALKING ON HANDS-FREE COMMUNICATION DEVICE 4 - TALKING ON HAND-HELD COMMUNICATION DEVICE 5 - OTHER ACTIVITY WITH AN ELECTRONIC DEVICE 6 - PASSENGER 7 - OTHER DISTRACTION INSIDE THE VEHICLE 8 - OTHER DISTRACTION OUTSIDE THE VEHICLE 9 - OTHER / UNKNOWN	1 - NONE GIVEN 2 - TEST REFUSED 3 - TEST GIVEN, CONTAMINATED SAMPLE / UNUSABLE 4 - TEST GIVEN, RESULTS KNOWN 5 - TEST GIVEN, RESULTS UNKNOWN
<b>INJURIES TAKEN BY</b>		<b>EJECTION</b>	<b>OL ENDORSEMENT</b>		<b>CONDITION</b>	<b>ALCOHOL TEST TYPE</b>
1 - NOT TRANSPORTED /TREATED AT SCENE 2 - EMS 3 - POLICE 9 - OTHER / UNKNOWN		1 - NOT EJECTED 2 - PARTIALLY EJECTED 3 - TOTALLY EJECTED 4 - NOT APPLICABLE	H - HAZMAT M - MOTORCYCLE P - PASSENGER N - TANKER Q - MOTOR SCOOTER R - THREE-WHEEL MOTORCYCLE S - SCHOOL BUS T - DOUBLE & TRIPLE TRAILERS X - TANKER / HAZMAT		1 - APPARENTLY NORMAL 2 - PHYSICAL IMPAIRMENT 3 - EMOTIONAL (E.G., DEPRESSED, ANGRY, DISTURBED) 4 - ILLNESS 5 - FELL ASLEEP, FAINTED, FATIGUED, ETC. 6 - UNDER THE INFLUENCE OF MEDICATIONS / DRUGS / ALCOHOL 9 - OTHER / UNKNOWN	1 - NONE 2 - BLOOD 3 - URINE 4 - BREATH 5 - OTHER
<b>SAFETY EQUIPMENT</b>		<b>TRAPPED</b>	<b>GENDER</b>			<b>DRUG TEST TYPE</b>
1 - NONE USED 2 - SHOULDER BELT ONLY USED 3 - LAP BELT ONLY USED 4 - SHOULDER & LAP BELT USED 5 - CHILD RESTRAINT SYSTEM - FORWARD FACING 6 - CHILD RESTRAINT SYSTEM - REAR FACING 7 - BOOSTER SEAT 8 - HELMET USED 9 - PROTECTIVE PADS USED (ELBOWS, KNEES, ETC) 10 - REFLECTIVE CLOTHING 11 - LIGHTING - PEDESTRIAN / BICYCLE ONLY 99 - OTHER / UNKNOWN		1 - NOT TRAPPED 2 - EXTRICATED BY MECHANICAL MEANS 3 - FREED BY NON-MECHANICAL MEANS	F - FEMALE M - MALE U - OTHER / UNKNOWN			<b>DRUG TEST RESULT(S)</b>
						1 - AMPHETAMINES 2 - BARBITURATES 3 - BENZODIAZEPINES 4 - CANNABINOIDS 5 - COCAINE 6 - OPIATES / OPIOIDS 7 - OTHER 8 - NEGATIVE RESULTS

# OCCUPANT / WITNESS ADDENDUM

LOCAL REPORT NUMBER  
25-OPD-0067

<b>OCCUPANT</b>	<b>UNIT #</b>	<b>NAME:</b> LAST, FIRST, MIDDLE			<b>DATE OF BIRTH</b>		<b>AGE</b>	<b>GENDER</b>	
	<b>ADDRESS:</b> STREET, CITY, STATE, ZIP				<b>CONTACT PHONE</b> - INCLUDE AREA CODE				
<b>INJURIES</b>	<b>INJURED TAKEN BY</b>	<b>EMS AGENCY (NAME)</b>	<b>INJURED TAKEN TO: MEDICAL FACILITY (NAME, CITY)</b>	<b>SAFETY EQUIPMENT</b>	<input type="checkbox"/> <b>DOT-COMPLIANT MC HELMET</b>	<b>SEATING POSITION</b>	<b>AIR BAG USAGE</b>	<b>EJECTION</b>	<b>TRAPPED</b>
<b>UNIT #</b>	<b>NAME:</b> LAST, FIRST, MIDDLE			<b>DATE OF BIRTH</b>		<b>AGE</b>	<b>GENDER</b>		
<b>ADDRESS:</b> STREET, CITY, STATE, ZIP				<b>CONTACT PHONE</b> - INCLUDE AREA CODE					
<b>INJURIES</b>	<b>INJURED TAKEN BY</b>	<b>EMS AGENCY (NAME)</b>	<b>INJURED TAKEN TO: MEDICAL FACILITY (NAME, CITY)</b>	<b>SAFETY EQUIPMENT</b>	<input type="checkbox"/> <b>DOT-COMPLIANT MC HELMET</b>	<b>SEATING POSITION</b>	<b>AIR BAG USAGE</b>	<b>EJECTION</b>	<b>TRAPPED</b>
<b>UNIT #</b>	<b>NAME:</b> LAST, FIRST, MIDDLE			<b>DATE OF BIRTH</b>		<b>AGE</b>	<b>GENDER</b>		
<b>ADDRESS:</b> STREET, CITY, STATE, ZIP				<b>CONTACT PHONE</b> - INCLUDE AREA CODE					
<b>INJURIES</b>	<b>INJURED TAKEN BY</b>	<b>EMS AGENCY (NAME)</b>	<b>INJURED TAKEN TO: MEDICAL FACILITY (NAME, CITY)</b>	<b>SAFETY EQUIPMENT</b>	<input type="checkbox"/> <b>DOT-COMPLIANT MC HELMET</b>	<b>SEATING POSITION</b>	<b>AIR BAG USAGE</b>	<b>EJECTION</b>	<b>TRAPPED</b>
<b>UNIT #</b>	<b>NAME:</b> LAST, FIRST, MIDDLE			<b>DATE OF BIRTH</b>		<b>AGE</b>	<b>GENDER</b>		
<b>ADDRESS:</b> STREET, CITY, STATE, ZIP				<b>CONTACT PHONE</b> - INCLUDE AREA CODE					
<b>INJURIES</b>	<b>INJURED TAKEN BY</b>	<b>EMS AGENCY (NAME)</b>	<b>INJURED TAKEN TO: MEDICAL FACILITY (NAME, CITY)</b>	<b>SAFETY EQUIPMENT</b>	<input type="checkbox"/> <b>DOT-COMPLIANT MC HELMET</b>	<b>SEATING POSITION</b>	<b>AIR BAG USAGE</b>	<b>EJECTION</b>	<b>TRAPPED</b>

<b>INJURIES</b>	<b>SAFETY EQUIPMENT USED</b>	<b>SEATING POSITION</b>	<b>AIR BAG USAGE</b>
1 - FATAL 2 - SUSPECTED SERIOUS INJURY 3 - SUSPECTED MINOR INJURY 4 - POSSIBLE INJURY 5 - NO APPARENT INJURY	1 - NONE USED - VEHICLE OCCUPANT 2 - SHOULDER BELT ONLY USED 3 - LAP BELT ONLY USED 4 - SHOULDER & LAP BELT USED 5 - CHILD RESTRAINT SYSTEM - FORWARD FACING 6 - CHILD RESTRAINT SYSTEM - REAR FACING 7 - BOOSTER SEAT 8 - HELMET USED 9 - PROTECTIVE PADS USED (ELBOWS, KNEES, ETC) 10 - REFLECTIVE CLOTHING 11 - LIGHTING - PEDESTRIAN / BICYCLE ONLY 99 - OTHER / UNKNOWN	1 - FRONT - LEFT SIDE (MOTORCYCLE DRIVER) 2 - FRONT - MIDDLE 3 - FRONT - RIGHT SIDE 4 - SECOND - LEFT SIDE (MOTORCYCLE PASSENGER) 5 - SECOND - MIDDLE 6 - SECOND - RIGHT SIDE 7 - THIRD - LEFT SIDE (MOTORCYCLE SIDE CAR) 8 - THIRD - MIDDLE 9 - THIRD - RIGHT SIDE 10 - SLEEPER SECTION OF TRUCK CAB 11 - PASSENGER IN OTHER ENCLOSED CARGO AREA (NON-TRAILING UNIT SUCH AS A BUS, PICK-UP WITH CAP) 12 - PASSENGER IN UNENCLOSED CARGO AREA 13 - TRAILING UNIT 14 - RIDING ON VEHICLE EXTERIOR (NON-TRAILING UNIT) 15 - NON-MOTORIST 99 - OTHER / UNKNOWN	1 - NOT DEPLOYED 2 - DEPLOYED FRONT 3 - DEPLOYED SIDE 4 - DEPLOYED BOTH FRONT/SIDE 5 - NOT APPLICABLE 9 - DEPLOYMENT UNKNOWN
<b>INJURED TAKEN BY</b>			<b>EJECTION</b>
1 - NOT TRANSPORTED / TREATED AT SCENE 2 - EMS 3 - POLICE 9 - OTHER / UNKNOWN			1 - NOT EJECTED 2 - PARTIALLY EJECTED 3 - TOTALLY EJECTED 4 - NOT APPLICABLE
<b>GENDER</b>			<b>TRAPPED</b>
F - FEMALE M - MALE U - OTHER / UNKNOWN			1 - NOT TRAPPED 2 - EXTRICATED BY MECHANICAL MEANS 3 - FREED BY NON-MECHANICAL MEANS

<b>WITNESS</b>	<b>NAME:</b> LAST, FIRST, MIDDLE	<b>DATE OF BIRTH</b>		<b>AGE</b>	<b>GENDER</b>
	<b>ADDRESS:</b> STREET, CITY, STATE, ZIP	<b>CONTACT PHONE</b> - INCLUDE AREA CODE			
<b>WITNESS</b>	<b>NAME:</b> LAST, FIRST, MIDDLE	<b>DATE OF BIRTH</b>		<b>AGE</b>	<b>GENDER</b>
	<b>ADDRESS:</b> STREET, CITY, STATE, ZIP	<b>CONTACT PHONE</b> - INCLUDE AREA CODE			
<b>WITNESS</b>	<b>NAME:</b> LAST, FIRST, MIDDLE	<b>DATE OF BIRTH</b>		<b>AGE</b>	<b>GENDER</b>
	<b>ADDRESS:</b> STREET, CITY, STATE, ZIP	<b>CONTACT PHONE</b> - INCLUDE AREA CODE			